

REVISIONS				
ECN	REV.	DESCRIPTION	DATE	APPROVED
	0.00	Initial	2013-06-04	
	0.01	Updated PN Info	2013-06-09	
	0.01b	Updated Template	2017-08-14	

**RJ-45 8P8C Female  
w/ Panel Mounts and Screws, Washers, Nuts**

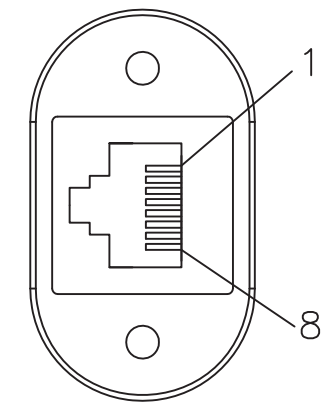

P1(8P8C JACK)

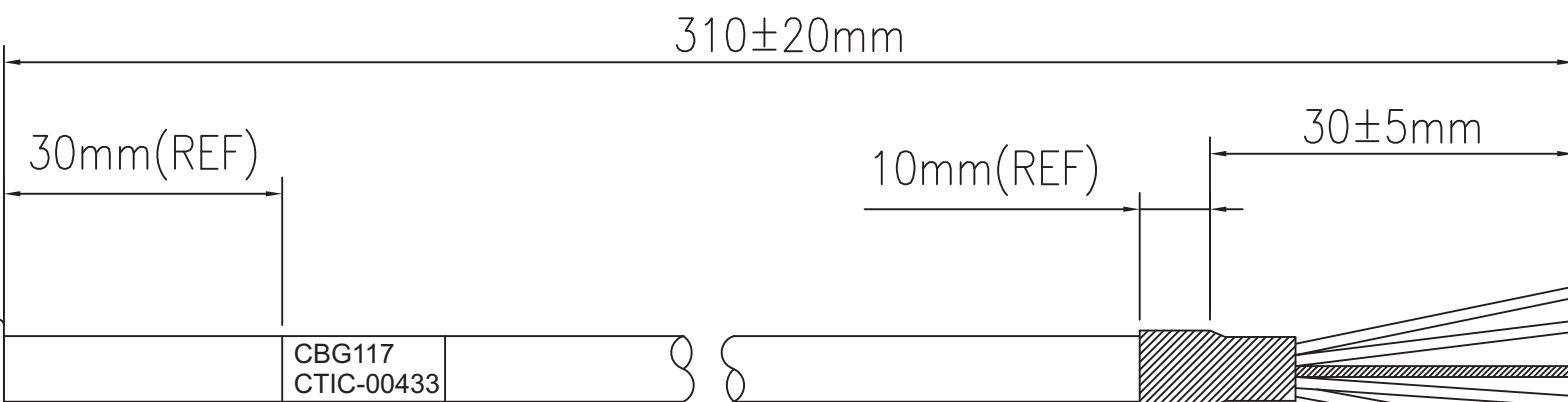
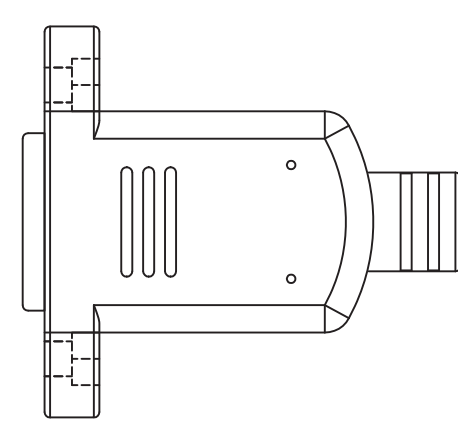

**FCI  
MiniTek 10-pin  
Housing  
PN:10073599-010LF**

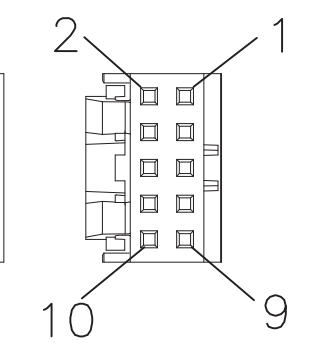

P2(10P HSG)

WHITE GROUND  
BLACK PRINTING

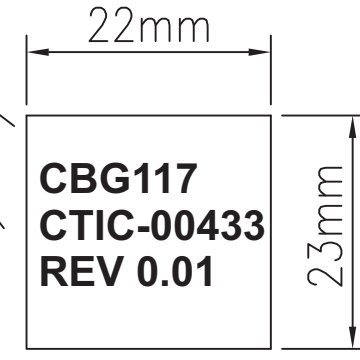

**CBG117  
CTIC-00433  
REV 0.01**

LABEL

**Pinout**

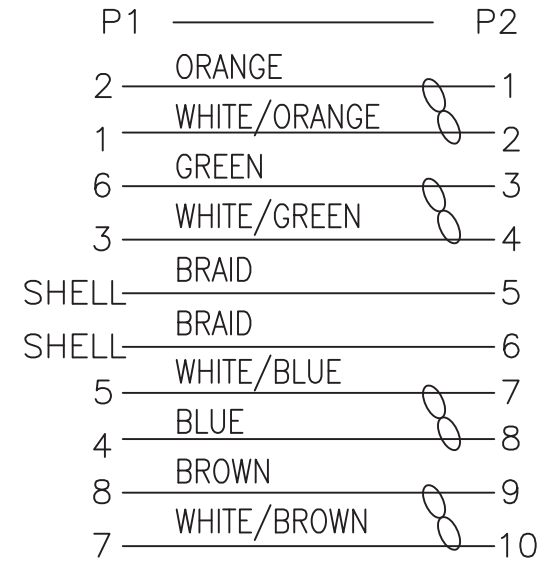

**Material Notes**

1. Cable is made from **RoHS** compliant components, must be RJ-45 compliant and 26-30 AWG
2. RJ-45 socket must be 8P8C (8 Pins, 8 Connectors)
3. FCI 10073599-010LF must be used; along with required crimps 77138

ASSEMBLY & TEST PROCEDURE:  
  
UNLESS OTHERWISE SPECIFIED:  
DIMENSIONS ARE IN METRIC (MM)  
  
THIS DRAWING AND SPECIFICATION SHOWN IS  
CONFIDENTIAL AND IS THE PROPERTY OF CONNECT  
TECH INCORPORATED. IT IS NOT TO BE REPRODUCED  
OR COPIED OR USED AS A BASIS TO MANUFACTURE  
ANYTHING SHOWN WITHOUT PRIOR WRITTEN  
PERMISSION OF CONNECT TECH INCORPORATED. ALL  
RIGHTS TO DESIGN OR INVENTION ARE RESERVED.

DRAWN <b>PD</b>	DATE <b>2017-08-14</b>
CHECKED	DATE
ENG APPR.	DATE
MFG APPR.	DATE
Q.A.	DATE

 **Connect Tech Inc.**  
Embedded Computing Experts  
42 ARROW ROAD, GUELPH, ON, CANADA, N1K 1S6

**NOT DRAWN TO SCALE**

TITLE <b>10-Minitek to RJ45F</b>	
PART NO. <b>CBG117</b>	REV <b>0.01b</b>
DOCUMENT NO. <b>CTIC-00433</b>	

## **CTIC-00048 ASSEMBLY SPECIFICATION**

This manual is a controlled document. It has been classified as such in order to ensure that concerned parties have access to the most current information. Copies are available from the Document Coordinator at Connect Tech.

**DO NOT REPRODUCE THIS MANUAL IN WHOLE OR IN PART**

CTIC-00048 Assembly Specification		
Doc # CTIC-00048	Rev: 0.00	October 29, 2001
		Page 1 of 4

# 1 Document Control

This manual is a controlled document. All issuance's and amendments will be controlled as per CTIQ-20003, Document control.

# 2 Revision History

Revision	Date	Description
0.00	October 29, 2001	Original

# 3 Specification

## 3.1 Overall View and Pinning Information

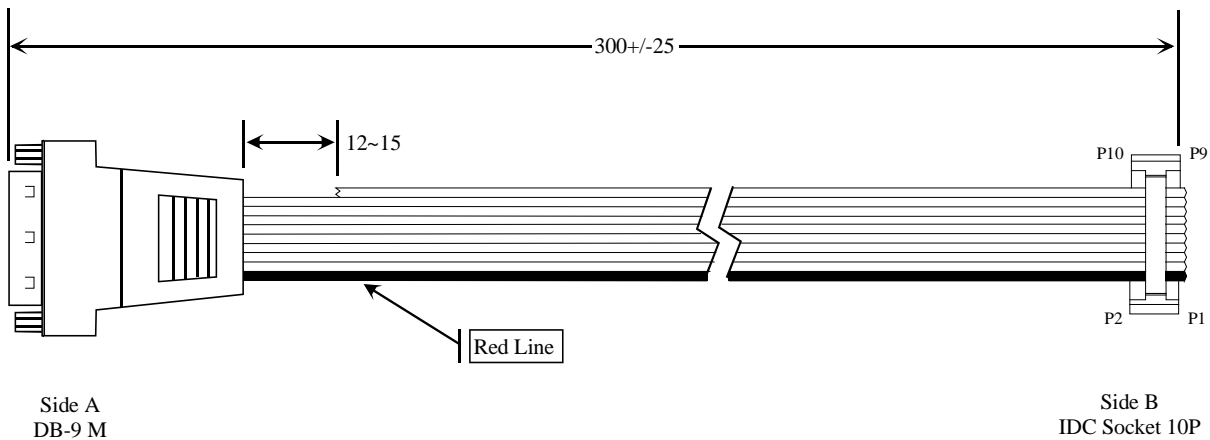

Wire List		
Side A	RED	Side B
1	_____	1
6	_____	2
2	_____	3
7	_____	4
3	_____	5
8	_____	6
4	_____	7
9	_____	8
5	_____	9
NC	_____	10

CTIC-00048 Assembly Specification

Doc # CTIC-00048	Rev: 0.00	October 29, 2001	Page 3 of 4
------------------	-----------	------------------	-------------

### 3.2 Assembly Notes.

- 1) For pinning information see section 3.1.
- 2) Cable Length is 300 +/- 25mm long.
- 3) Cable:  
Flat cable, 28AWG (7/0.127) Tinned and Standed Copper.  
10 conductors, 1.27mm pitch.  
Jacket is grey PVC.  
UL2651 approved.
- 4) Hex nuts and screws, #4-40UNC to be applied to DB9 SIDEA
- 5) DB9 end is covered with assembly type black hood.
- 6) 10P IDC is phosphor bronze with black colour, pitch: 2.54mm.
- 7) The 10<sup>th</sup> conductor is unused, please cut it back as shown in diagram in section 3.1.

### 4 Other Notes

---

The cable, CTIC-00048 is used for CTI cable CAB104 ( CTIC-00049 ).

### 5 Test Procedure

---

Continuity, short circuit and missing wire tests to be performed by supplier/manufacturer.

CTIC-00048 Assembly Specification		
Doc # CTIC-00048	Rev: 0.00	October 29, 2001
		Page 4 of 4